



**iFORM**



# WIN WIN COOPERATION AND PROGRESS HAND IN HAND

iFORM ENGINEERING LIMITED

---

Unit 1110, Shun Fat Industrial Building  
No.17 Wang Hoi Road, Kowloon Bay, Hong Kong  
Tel: +852 3618 7874  
Email: [info@iform.hk](mailto:info@iform.hk)



## About us

iFORM specializes in supplying fasteners and fixing systems. Our mission is to supply high quality and durable products with competitive prices to our valuable Clients.

Our products range from standard bolts and nuts to high strength friction grip bolts, Cust-in channels, threaded bars with different material properties, surface treatment and compliance with various national standards. They are suitable for heavy duty structural works under different extreme conditions.

Our partnering factories are experienced leading manufacturers in the construction markets. Our products have been sampled and tested to various standards such as China National Accreditation Service for Conformity Assessment (CNAS), Hong Kong Laboratories Accredited Scheme (HOKLAS) and American Petroleum Institute (API) standards. Material mill certificates, test results after product completion will be provided with our deliveries. Our employees are well trained and we are eager to provide technical advice and solutions to suit for the Client's needs.







# CAST IN SYSTEM



**Cast-in Channels**

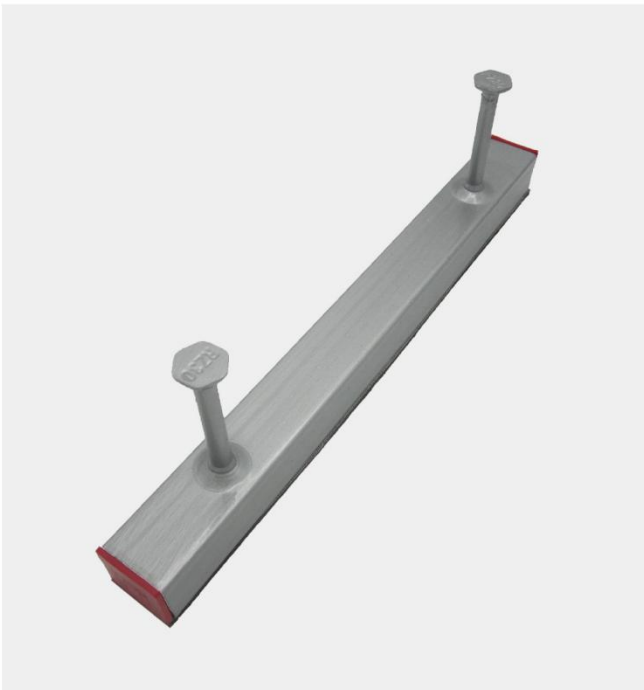

**Cast-in Channels**



**Cast-in Channels**



**T-bolts(Flat tooth)**



**T-bolts(stainless steel)**



**T-bolts(Swallowtail)**

# STAINLESS STEEL

## 不銹鋼



牙條/螺柱  
THREADED BAR/THREAD STUD BOLTS



六角頭-全螺紋  
HEXHEAD SCREWS



內六角螺釘  
HEXAGON SOCKET CAP SCREWS



六角螺母  
HEXAGON NUTS



方螺母-C級  
SQUARE NUTS-C



蓋形螺母  
HEXAGON CAP NUTS





尼龍鎖緊螺母  
NYLON LOCK NUTS



蝶形螺母  
BUTTERFLY NUTS



六角法蘭面螺母  
HEXAGON NUTS WITH FLANGE



平墊圈  
FLAT WASHERS



彈簧墊圈  
SPRING WASHERS



內六角平圓頭螺釘  
HEXAGON SOCKET BUTTON HEAD SCREWS



組合作件  
COMPOSITE MEMBER



十字槽盤頭機械螺釘  
PAN HEAD MACHINE SCREW



十字槽盤頭自攻螺釘  
PAN HEAD SELF TAPPING SCREW



四方焊接螺母  
SQUARE WELD NUTS

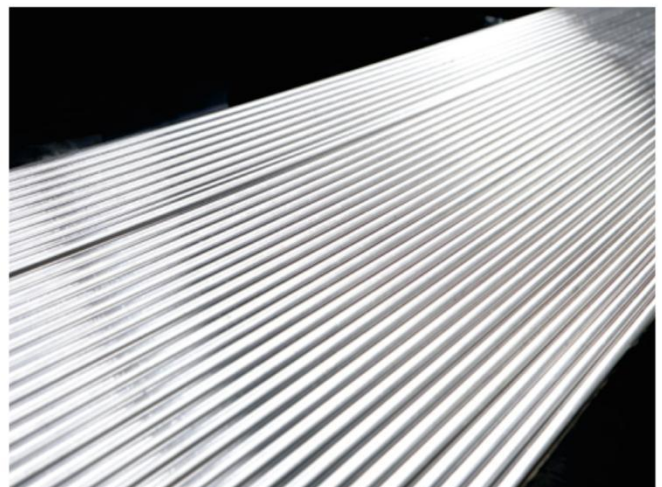

牙條  
THREADED BAR

組合作件  
COMPOSITE MEMBER



大半圓頭馬車螺栓  
ROUND HEAD CARRIAGE BOLT



膨脹螺栓  
EXPANSION BOLT



內六角螺釘  
HEXAGON SOCKET CAP SCREWS

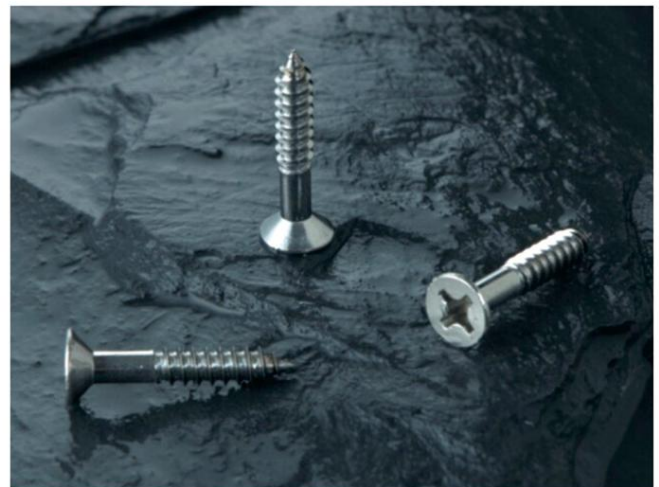

十字槽沉頭自攻螺釘  
COUNTERSUNK HEAD SELF TAPPING SCREW

# HOT DIP GALVANIZED AND ZINC PLATED PRODUCT

## 熱鍍鋅及鍍白鋅產品



熱鍍鋅螺母  
HOT DIP GALVANIZED NUT



鍍白鋅螺母  
WHITE ZINC PLATING NUT



熱鍍鋅螺柱  
HOT DIP GALVANIZED STUD BOLT



鍍白鋅螺柱  
WHITE ZINC PLATING STUD BOLT



熱鍍鋅螺栓  
HOT DIP GALVANIZED BOLT



鍍白鋅螺栓  
WHITE ZINC PLATING BOLT

## SURFACE TREATMENT

## 表面處理

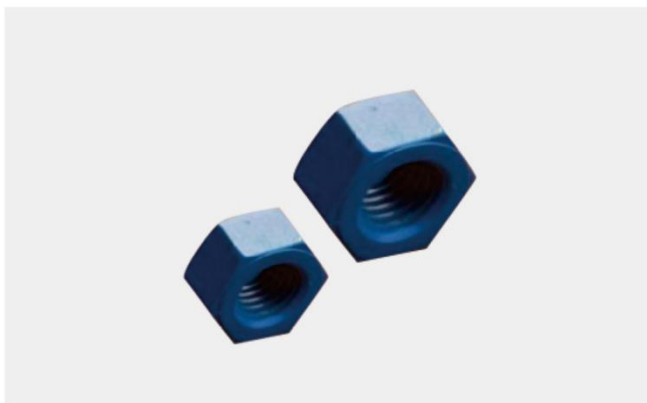

藍色PTFE螺母  
BLUE PTFE NUT



鍍黃鋅螺母  
YELLOW GALVANIZED NUT



藍色PTFE螺柱  
BLUE PTFE STUD BOLT



鍍鎘螺柱  
CADMIUM PLATING STUD BOLT



藍色PTFE螺栓  
BLUE PTFE BOLT



組合件  
COMPOSITE MEMBER

# SURFACE TREATMENT

## 表面處理



全螺紋  
FULL THREADED



內六角螺絲  
HEXAGON SOCKET SCREWS



單頭螺柱  
SINGLE END STUD

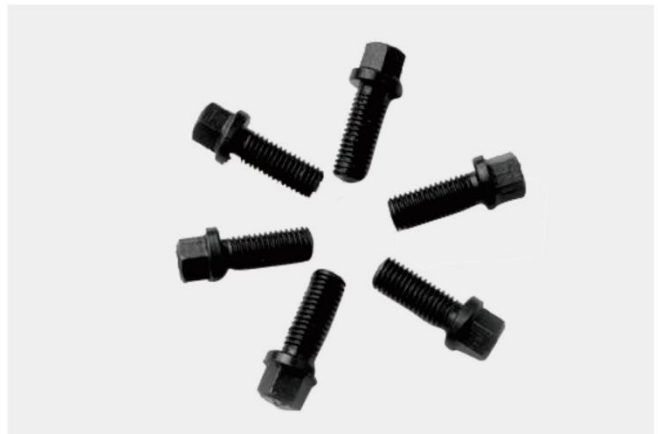

六角法蘭面螺栓  
HEXAGON FLANGE BOLT



雙頭螺柱  
STUDS BOLTS



外六角螺栓  
HEXAGON HEAD BOLTS (PARTIAL THREAD)



活節螺栓  
EYE BOLTS



高强度结构螺栓  
HIGH STRENGTH STRUCTURAL BOLTING  
BS EN 14399-10



内六角螺栓  
HEXAGON SOCKET SCREWS



高强度结构螺栓  
HIGH STRENGTH STRUCTURAL BOLTING  
BS EN 14399-10



高强度结构螺栓  
HIGH STRENGTH STRUCTURAL BOLTING  
GB 1228/1229



高强度结构螺栓  
HIGH STRENGTH STRUCTURAL BOLTING  
AS 1252

## DIN933 STEEL HEXAGON NUTS

Stainless Steel/Hot Dip Galvanized and Zinc Plated(A2-70/A4-70/A4-80&Grade 8)

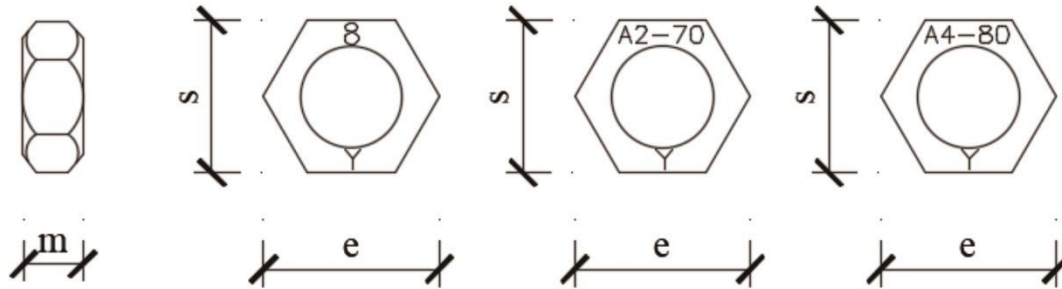

Material Standard: ISO 3506/ISO 898-2009  
 Specification : DIN 933  
 Hot Dip Galvanized: ISO 1461-2009/ISO 10684  
 Zinc Plated: ISO 4042

Unit: mm

nominal size and thread diameter	width across flats		width across corners		height	
	s		e		k	
	min	max	min	max	min	max
M5	7.78	8.00	8.79		3.70	4.00
M6	9.78	10.00	11.05		4.70	5.00
M8	12.73	13.00	14.38		6.14	6.50
M10	16.73	17.00	18.90		7.64	8.00
M12	18.67	19.00	21.10		9.64	10.00
M16	24.00	24.00	26.75		12.30	13.00
M20	30.00	30.00	32.95		14.90	16.00
M24	35.00	36.00	39.55		17.70	19.00
M27	40.00	41.00	42.20		20.70	22.00
M30	45.00	46.00	50.85		22.70	24.00
M36	53.80	55.00	60.79		27.40	29.00
M42	63.10	65.00	71.30		32.40	34.00
M48	73.10	75.00	82.60		38.00	38.00



## DIN933-1987 STEEL HEXAGON HEAD BOLTS (FULL THREAD)

Stainless Steel/Hot Dip Galvanized and Zinc Plated(A2-70/A4-70/A4-80&Grade 4.8/8.8)

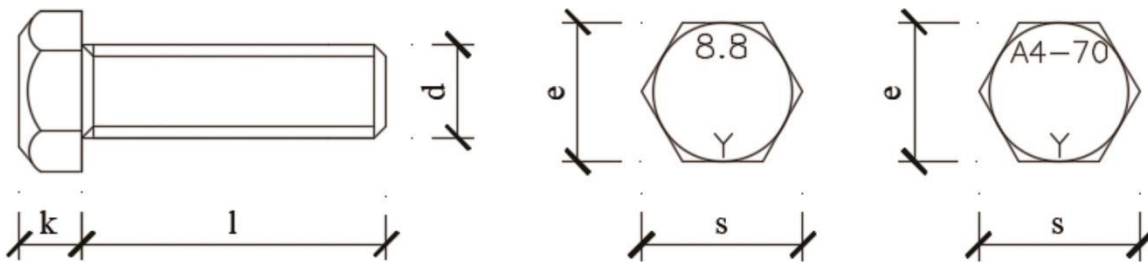

Material Standard: ISO 3506/ISO 898-2009  
 Specification : DIN 933  
 Hot Dip Galvanized: ISO 1461-2009/ISO 10684  
 Zinc Plated: ISO 4042

Unit: mm

nominal size and thread diameter	width across flats		width across corners		height	
	s		e		k	
size	grade A	grade B	grade A	grade B	min	max
M6	9.78	-	11.05	-	3.85	4.15
M8	12.73	-	14.38	-	5.15	5.45
M10	16.73	-	18.90	-	6.22	6.56
M12	18.67	-	21.10	-	7.32	7.68
M16	23.67	-	26.75	-	9.82	10.18
M20	29.67	-	33.53	-	12.28	12.72
M24	35.38	-	35.72	-	14.78	15.22
M27	-	40.00	39.98	-	16.65	17.35
M30	-	45.00	-	50.85	18.28	19.12
M36	-	53.80	-	60.79	22.08	22.92
M42	-	63.10	-	71.30	25.58	26.42
M48	-	73.10	-	82.60	29.50	40.42

## DIN933 STEEL HEXAGON NUTS

Stainless Steel/Hot Dip Galvanized and Zinc Plated(A2-70/A4-70/A4-80&Grade 8)

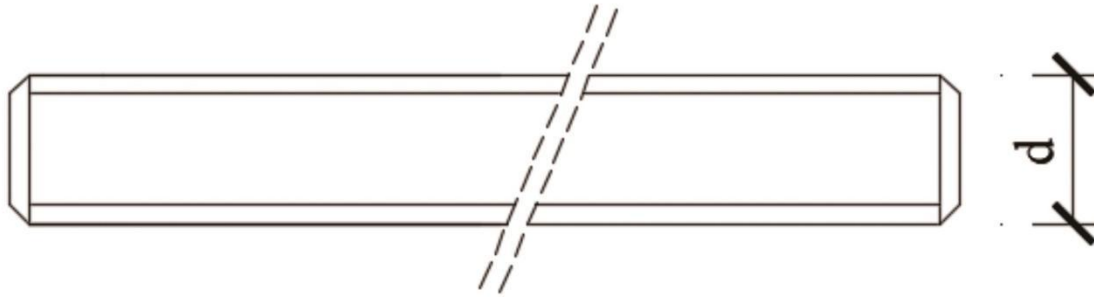

Material Standard: ISO 3506/ISO 898-2009  
 Specification : DIN 933  
 Hot Dip Galvanized: ISO 1461-2009/ISO 10684  
 Zinc Plated: ISO 4042

Unit: mm

nominal size and thread diameter	width across flats		width across corners		height	
	s		e		k	
	min	max	min	max	min	max
M5	7.78	8.00	8.79		3.70	4.00
M6	9.78	10.00	11.05		4.70	5.00
M8	12.73	13.00	14.38		6.14	6.50
M10	16.73	17.00	18.90		7.64	8.00
M12	18.67	19.00	21.10		9.64	10.00
M16	24.00	24.00	26.75		12.30	13.00
M20	30.00	30.00	32.95		14.90	16.00
M24	35.00	36.00	39.55		17.70	19.00
M27	40.00	41.00	42.20		20.70	22.00
M30	45.00	46.00	50.85		22.70	24.00
M36	53.80	55.00	60.79		27.40	29.00
M42	63.10	65.00	71.30		32.40	34.00
M48	73.10	75.00	82.60		38.00	38.00

## DIN931-1-1987 STEEL HEXAGON HEAD BOLTS(PARTIAL THREAD)

Stainless Steel/Hot Dip Galvanized and Zinc Plated(A2-70/A4-70/A4-80&Grade 4.8/8.8)

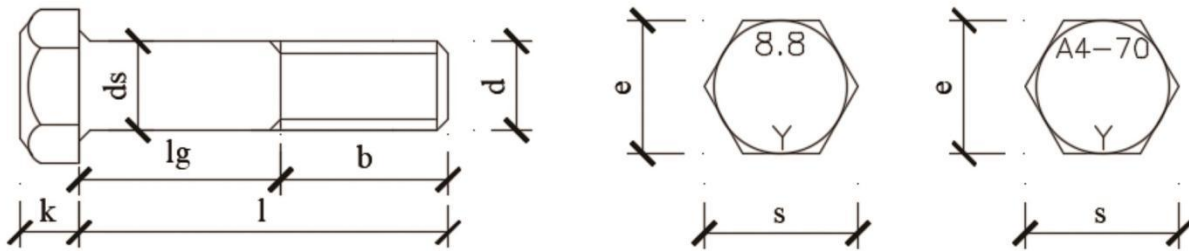

Material Standard: ISO 3506/ISO 898-2009  
 Specification : DIN 931  
 Hot Dip Galvanized: ISO 1461-2009/ISO 10684  
 Zinc Plated: ISO 4042

Unit: mm

nominal size and thread diameter	width across flats		width across corners		height of head		diameter of unthreaded shank	
	e		s		k(grade A)		ds	
size	grade A	grade B	grade A	grade B	min	max	grade A	grade B
M5	9.78	-	11.05	-	3.85	4.15	5.82	-
M6	12.73	-	14.38	-	5.15	5.45	7.78	-
M8	16.73	-	18.90	-	6.22	6.58	9.78	-
M10	18.67	-	21.10	-	7.32	7.68	11.73	-
M12	23.67	-	26.75	-	9.82	10.18	15.73	-
M16	29.67	-	33.53	-	12.28	12.72	19.67	15.57
M20	35.38	-	39.98	-	14.78	15.22	23.67	19.48
M24	-	40.00	-	45.20	16.65	17.35	-	23.48
M30	-	45.00	-	50.85	18.28	19.12	-	29.48
M36	-	53.80	-	60.79	22.92	22.92	-	35.38

## DIN 125 STEEL FLAT WASHERS

Stainless Steel/Hot Dip Galvanized and Zinc Plated

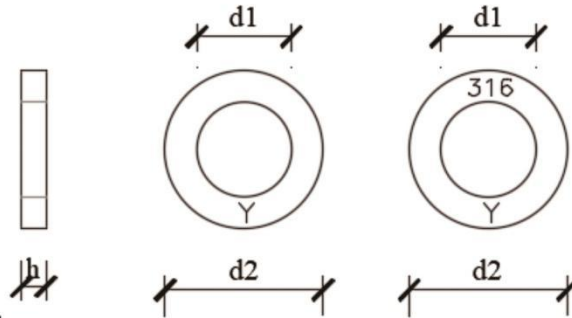

Material Standard: ISO 3506/ISO 670-2007  
 Specification : DIN 125  
 Hot Dip Galvanized: ISO 1461-2009/ISO 10684  
 Zinc Plated: ISO 4042

Unit: mm

nominal size and thread diameter	width across flats		width across corners		thickness	
	s		e		m	
size	min	max	min	max	min	max
M5	5.30	5.48	9.64	10.00	0.90	1.10
M6	6.40	6.62	11.57	12.00	1.40	1.80
M8	8.40	8.62	15.57	16.00	1.40	1.80
M10	10.50	10.77	19.48	20.00	1.80	2.20
M12	13.00	13.27	23.48	24.00	2.30	2.70
M14	15.00	15.27	27.48	28.00	2.30	2.70
M16	17.00	17.27	29.48	30.00	2.70	3.30
M20	21.00	21.33	36.38	37.00	2.70	3.30
M24	25.00	25.33	43.38	44.00	3.70	4.30
M30	31.00	31.39	55.26	56.00	3.70	4.30
M36	37.00	37.62	64.80	66.00	4.40	5.60

# DIN 127 STEEL FLAT WASHERS

Stainless Steel/Hot Dip Galvanized and Zinc Plate

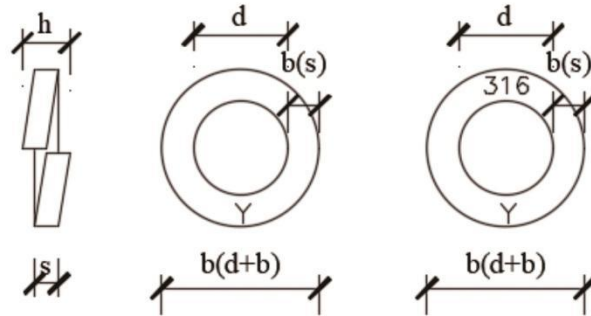

Material Standard: ISO 3506 / ISO 898-2009  
 Specification : DIN 127  
 Hot Dip Galvanized: ISO 1461-2009/ISO 10684  
 Zinc Plated: ISO 4042

Unit: mm

nominal size and thread diameter	inside diameter		outside diameter		height	
	d		b(d+b)		h	
size	min	max	min	max	min	max
M2	2.1	2.35	0.42	0.58	1	1.325
M2.5	2.6	2.85	0.57	0.73	1.3	1.63
M3	3.1	3.4	0.7	0.9	1.6	2
M4	4.1	4.4	1	1.2	2.2	2.75
M5	5.1	5.4	1.2	1.4	2.6	3.25
M6	6.1	6.68	1.5	1.7	3.2	4
M8	8.1	8.68	2	2.2	4.2	5.25
M10	10.2	10.9	2.45	2.75	5.2	6.5
M12	12.2	12.9	2.95	3.25	6.2	7.75
M14	14.2	14.9	3.4	3.8	7.2	9
M16	16.2	16.9	3.9	4.3	8.2	10.25
M18	18.2	19.04	4.3	4.7	9	11.25
M20	20.2	21.04	4.8	5.2	10	12.5
M22	22.5	23.34	5.3	5.7	11	13.75
M24	24.5	25.5	5.8	6.2	12	15
M27	27.5	28.5	6.5	7.1	13.6	17
M30	30.5	31.5	7.2	7.8	15	18.75
M33	33.5	34.7	8.2	8.8	17	21.25
M36	36.5	37.7	8.7	9.3	18	22.5
M39	39.5	40.7	9.7	10.3	20	25
M42	42.5	43.7	10.2	10.8	21	26.25
M45	45.5	46.7	10.7	11.3	22	27.5
M48	48.5	49.7	11.7	12.3	24	30

## BS 4190 STEEL HEXAGON NUTS

Hot Dip Galvanized and Zinc Plated(Grade 4/8)

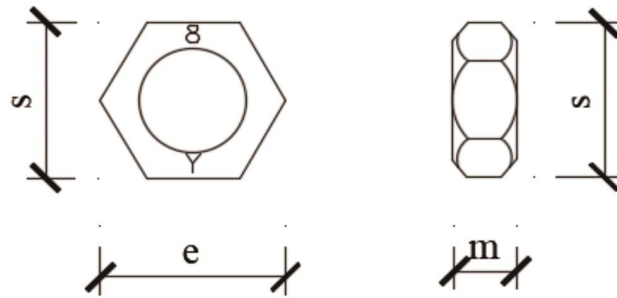

Material Standard: ISO 898-2009  
 Specification : BS 4190/ISO 4014  
 Hot Dip Galvanized: ISO 1461-2009/ISO 10684  
 Zinc Plated: ISO 4042

Unit: mm

nominal size and thread diameter	width across flats		width across corners		thickness	
	s		e		m	
size	min	max	min	max	min	max
M5	7.64	8.00	8.63	9.20	3.63	4.38
M6	9.64	10.00	10.89	11.50	4.63	5.38
M8	12.57	13.00	14.20	15.00	6.13	6.88
M10	16.57	17.00	18.72	19.60	7.55	8.45
M12	18.48	19.00	20.88	21.90	9.55	10.45
M16	23.16	24.00	26.17	27.70	12.45	13.55
M20	29.16	30.00	32.95	34.60	15.45	16.55
M22	31.00	32.00	35.05	36.90	17.45	18.55
M24	35.00	36.00	39.55	41.60	18.35	19.65
M27	40.00	41.00	45.20	47.30	21.35	22.65
M30	45.00	46.00	50.85	53.10	23.35	24.65
M33	49.00	50.00	55.37	57.70	25.35	26.65
M36	53.80	55.00	60.79	63.50	28.35	29.65
M39	58.80	60.00	66.44	69.30	30.20	31.80
M42	63.80	65.00	72.09	75.10	33.20	34.80
M45	68.80	70.00	77.74	80.80	35.20	36.80
M48	73.80	75.00	83.39	86.60	37.20	38.80
M52	78.80	80.00	89.04	92.40	41.20	42.80
M56	83.60	85.00	94.47	98.10	44.20	45.80
M60	88.60	90.00	100.12	103.90	47.20	48.80

## BS 4190 HEXAGON HEAD BOLTS (PARTIAL THREAD)

Hot Dip Galvanized and Zinc Plated(Grade 4.8/8.8)

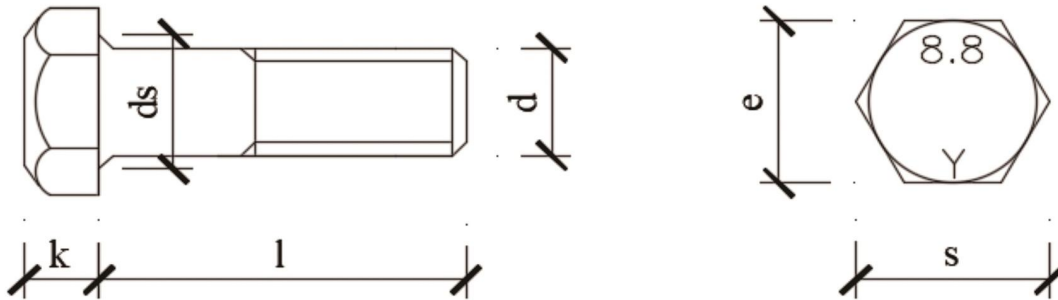

Material Standard: ISO 898-2009  
 Specification : BS 4190/ISO 4014  
 Hot Dip Galvanized: ISO 1461-2009/ISO 10684  
 Zinc Plated: ISO 4042

Unit: mm

nominal size and thread diameter	width across flats		width across corners		height of head		diameter of unthreaded shank	
	e		s		k		ds	
size	min	max	min	max	min	max	min	max
M5	7.64	8.00	8.63	9.20	3.13	3.88	4.52	5.48
M6	9.64	10.00	10.89	11.50	3.63	4.38	5.50	6.48
M8	12.57	13.00	14.20	15.00	5.13	5.88	7.42	8.58
M10	16.57	17.00	18.72	19.60	6.55	7.45	9.42	10.58
M12	18.48	19.00	20.88	21.90	7.55	8.45	11.30	12.70
M16	23.16	24.00	26.17	27.70	9.55	10.45	15.30	16.70
M20	29.16	30.00	32.95	34.60	12.10	13.90	19.16	20.84
M22	31.00	32.00	35.03	36.90	13.10	14.90	21.16	22.84
M24	35.00	36.00	39.55	41.60	14.10	15.90	23.16	24.84
M27	40.00	41.00	45.20	47.30	16.10	17.90	26.16	27.84
M30	45.00	46.00	50.85	53.10	17.95	20.05	29.16	30.84
M33	49.00	50.00	55.37	57.70	19.95	22.05	32.00	34.00
M36	53.80	55.00	60.79	63.50	21.95	24.05	35.00	37.00
M39	58.80	60.00	66.44	69.30	23.95	26.05	38.00	40.00
M42	63.80	65.00	72.09	75.10	24.95	27.05	41.00	41.00
M45	68.80	70.00	77.74	80.80	26.95	29.05	44.00	46.00
M48	73.80	75.00	83.39	86.60	28.95	31.05	47.00	49.00
M52	78.80	80.00	89.04	92.40	31.75	34.25	50.80	53.20
M56	83.60	85.00	94.47	98.10	33.75	36.26	54.80	57.20
M60	88.60	90.00	100.12	103.90	36.75	39.25	58.80	61.20
M64	93.60	95.00	105.77	109.70	38.75	41.25	62.80	65.20
M68	98.60	100.00	111.42	115.50	41.75	44.25	62.80	69.20

## BS 4190 STEEL HEXAGON HEAD BOLTS (FULL THREAD)

Hot Dip Galvanized and Zinc Plated(Grade 4.8/8.8)

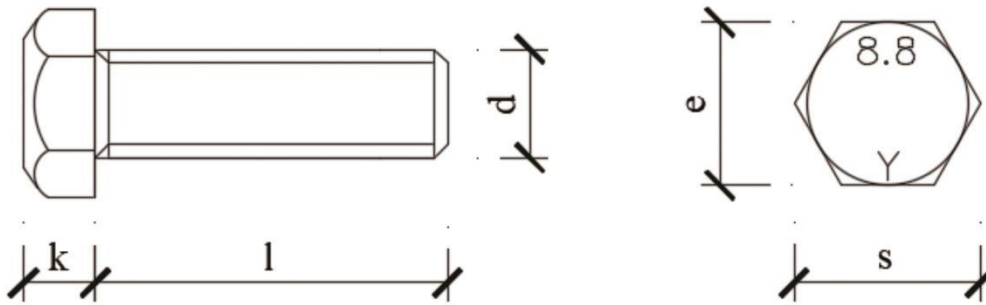

Material Standard: ISO 898-2009  
 Specification : BS 4190/ISO 4014  
 Hot Dip Galvanized: ISO 1461-2009/ISO 10684  
 Zinc Plated: 4042

Unit: mm

nominal size and thread diameter	width across flats		width across corners		height of head	
	e		s		k	
size	min	max	min	max	min	max
M5	7.64	8.00	8.63	9.20	3.13	3.88
M6	9.64	10.00	10.89	11.50	3.63	4.38
M8	12.57	13.00	14.20	15.00	5.13	5.88
M10	16.57	17.00	18.72	19.60	6.55	7.45
M12	18.48	19.00	20.88	21.90	7.55	8.45
M16	23.16	24.00	26.17	27.70	9.55	10.45
M20	29.16	30.00	32.95	34.60	12.10	13.90
M22	31.00	32.00	35.03	36.90	13.10	14.90
M24	35.00	36.00	39.55	41.60	14.10	15.90
M27	40.00	41.00	45.20	47.30	16.10	17.90
M30	45.00	46.00	50.85	53.10	17.95	20.05
M33	49.00	50.00	55.37	57.70	19.95	22.05
M36	53.80	55.00	60.79	63.50	21.95	24.05
M39	58.80	60.00	66.44	69.30	23.95	26.05
M42	63.80	65.00	72.09	75.10	24.95	27.05
M45	68.80	70.00	77.74	80.80	26.95	29.05
M48	73.80	75.00	83.39	86.60	28.95	31.05
M52	78.80	80.00	89.04	92.40	31.75	34.25
M56	83.60	85.00	94.47	98.10	33.75	36.26
M60	88.60	90.00	100.12	103.90	36.75	39.25
M64	93.60	95.00	105.77	109.70	38.75	41.25
M68	98.60	100.00	111.42	115.50	41.75	44.25



## BS 4320 STEEL FLAT WASHERS

Hot Dip Galvanized and Zinc Plate

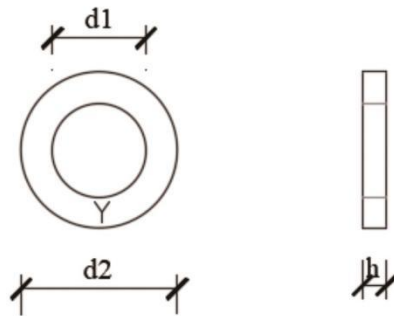

Material Standard: ISO 898-2009  
 Specification : BS 4320/ISO 7089  
 Hot Dip Galvanized: ISO 1461-2009/ISO 10684  
 Zinc Plated: 4042

Unit: mm

nominal size and thread diameter	inside diameter		outside diameter		thickness	
	d1		d2		h	
size	min	max	min	max	min	max
M1.6	1.70	1.85	3.70	4.00	0.20	0.40
M2	2.20	2.35	4.70	5.00	0.20	0.40
M2.5	2.70	2.85	6.20	6.50	0.40	0.40
M3	3.20	3.40	6.70	7.00	0.40	0.60
M4	4.30	4.50	8.70	9.00	0.70	0.90
M5	5.30	5.50	9.70	10.00	0.90	1.10
M6	6.40	6.70	12.10	12.50	1.40	1.80
M8	8.40	8.70	16.60	17.00	1.40	1.80
M10	10.50	10.90	20.50	21.00	1.80	2.20
M12	13.00	13.40	23.50	24.00	2.30	2.70
M14	15.00	15.40	27.50	28.00	2.30	2.70
M16	17.00	17.40	29.50	30.00	2.70	3.30
M20	21.00	21.50	36.20	37.00	2.70	3.30
M24	25.00	25.50	43.20	44.00	3.70	4.30
M30	31.00	31.60	55.00	56.00	3.70	4.30
M33	34.00	34.60	59.00	60.00	4.40	5.60
M36	37.00	37.60	65.00	66.00	4.40	5.60

# BS EN 14399-10 HIGH STRENGTH STRUCTURAL NUTS

Hot Dip Galvanized and Black (Grade 8/10)

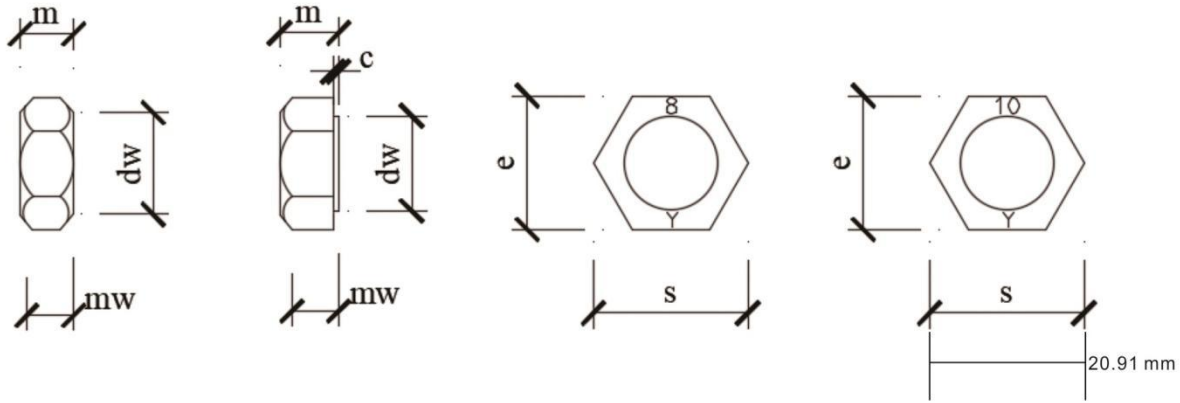

Material Standard: ISO 898-2009  
 Specification : BS EN 14399-10  
 Hot Dip Galvanized: ISO 1461-2009/ISO 10684  
 Zinc Plated: ISO 11048-1999/GB T15519-2002

Unit: mm

nominal size and thread diameter	dw		e	m		mw	c		s	
	max	min	min	max	min	min	max	min	max	min
M12	-	20.1	23.91	10.08	10.37	8.3	0.8	0.40	22	21.16
M16	-	24.9	29.56	14.8	14.1	11.3	0.8	0.40	27	26.16
M20	-	29.5	35.03	18	16.9	13.5	0.8	0.40	32	31
M22	-	33.3	39.55	19.4	18.1	14.5	0.8	0.40	36	35
M24	-	38	45.2	21.5	20.2	16.2	0.8	0.40	41	40
M27	-	42.8	50.85	23.8	22.5	18.1	0.8	0.40	46	45
M30	-	46.6	55.37	25.6	24.3	19.5	0.8	0.40	50	49

# BS EN 14399-5 HIGH STRENGTH STRUCTURAL FLAT WASHER

Hot Dip Galvanized and Black

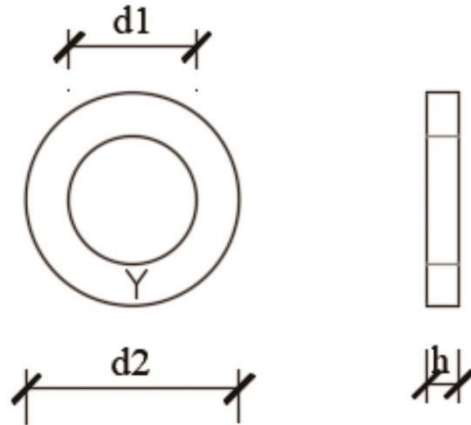

Material Standard: ISO 898-2009  
 Specification : BS EN 14399-5  
 Hot Dip Galvanized: ISO 1461-2009/ISO 10684  
 Zinc Plated: ISO 11048-1999/GB T15519-2002

Unit: mm

nominal size and thread diameter	d1		d2		h		
	min	max	min	max	nom	min	max
M12	13	13.27	23.48	24	3	3.7	3.3
M16	17	17.27	29.48	30	4	3.7	4.3
M20	21	21.33	36.38	37	4	3.7	4.3
M22	23	23.33	38.38	39	4	3.7	4.3
M24	25	25.33	43.38	44	4	3.7	4.3
M27	28	28.52	48	50	5	4.4	5.6
M30	31	31.62	54.8	56	5	4.4	5.6

## STEEL SPRING WASHERS

Hot Dip Galvanized and Zinc Plated

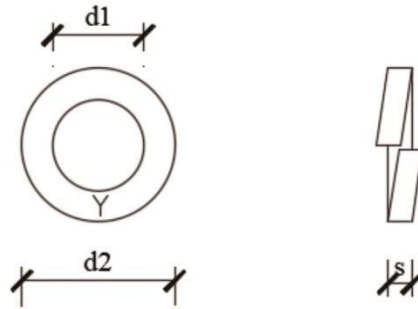

Material Standard: ISO 898-2009  
 Specification : DIN 127-B:1987  
 Hot Dip Galvanized: ISO 1461-2009/ISO 10684  
 Zinc Plated: ISO 4042

Unit: mm

nominal size and thread diameter	inside diameter		outside diameter	height	
	d1		d2	s	
size	min	max	max	min	max
M2	2.1	2.5	4.4	1	1.2
M2.5	2.6	2.9	5.1	1.2	1.4
M3	3.1	3.4	6.2	1.6	1.9
M4	4.1	4.4	7.6	1.8	2.1
M5	5.1	5.4	9.2	2.4	2.8
M6	6.1	6.5	11.8	3.2	3.8
M8	8.1	8.5	14.8	4	4.7
M10	10.2	10.7	18.1	4.4	5.2
M12	12.2	12.7	21.1	5	5.9
M14	14.2	14.7	24.1	6	7.1
M16	16.2	17	27.4	7	8.3
M18	18.2	19	29.4	7	8.3
M20	20.2	21.2	33.6	8	9.4
M22	22.5	23.5	35.9	8	9.4
M24	24.5	25.5	40	10	11.8
M27	27.5	28.5	43	10	11.8
M30	30.5	31.7	48.2	12	14.2
M33	33.5	34.7	53.2	12	14.25
M36	36.5	37.7	58.2	12	14.2
M39	39.5	40.7	61.2	12	14.2
M42	42.5	43.7	68.2	14	16.5
M45	45.5	46.7	71.2	14	16.5
M48	49	50.5	75	14	16.5

# BS EN 14399-10 HIGH STRENGTH STRUCTURAL BOLTING FOR PRELOADING

Hot Dip Galvanized and Black(Grade 7.8/10.9)

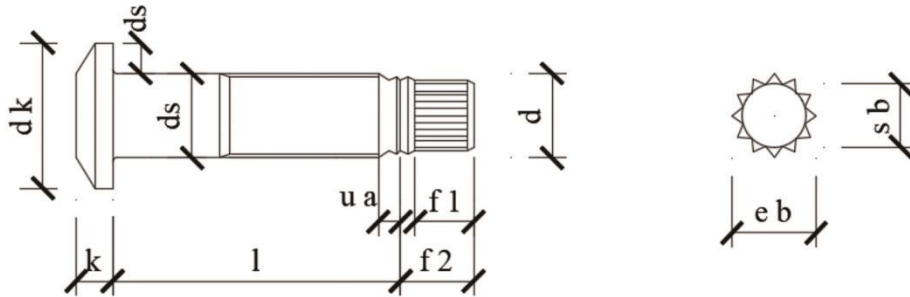

Material Standard: ISO 898-2009  
 Specification : BS EN 14399-10  
 Hot Dip Galvanized: ISO 1461-2009/ISO 10684  
 Zinc Plated: ISO 11048-1999/GB T15519-2002

Unit: mm

nominal size and thread diameter	dk		dw	k			sb			eb	f1	f2	l		
	min	max	min	nom	max	min	nom	max	min	min	min	max	nom	max	min
M12	21	20	20	8	8.8	7.2	7.7	8	4.4	8.36	11	16	40	41.25	38.75
M16	27	26	26	10	10.8	9.2	11.3	11.3	11	12.43	13	18	50	51.25	48.75
M20	34	33	33	13	13.9	12.1	14.1	14.4	13.8	15.6	15	20	60	61.5	58.5
M22	38.5	37	37	14	14.9	13.1	15.4	15.7	15.1	17.06	15.5	21	70	71.5	68.5
M24	43	41	41	15	15.9	14.1	16.8	17.1	16.5	18.65	16	21.5	80	81.8	78.5
M27	48	46	46	17	17.9	16.1	19	19.3	18.7	21.13	19	24	80	81.5	78.5
M30	52	50	50	19	20	18	21.1	21.4	20.8	23.5	21	26	90	91.75	88.25

# ISO 4014-2011 HEXAGON HEAD SCREWS(PARTIAL THREAD)

Hot Dip Galvanized / Zinc plated& Black (Grade 8.8/10.9)



Material Standard: ISO 898-1  
 Specification : ISO 4014  
 Hot Dip Galvanized: ISO 1461-2009/ISO 10684  
 Zinc Plated: ISO 4042  
 Black plated : ISO 11048-1999

Unit: mm

Nominal size and thread diameter d	p		b			d <sub>1</sub>		e		k				s			
	pitch of thread	L ≤ 125	125 < L ≤ 200	L > 200	nomal	grade A	grade B	grade A	grade B	nomal	grade A		grade B		max	grade A	grade B
						min	min	min	min		max	min	max	min		min	min
M6	1	18	24	37	6	5.82	5.7	11.05	10.89	4	4.15	3.85	4.24	3.76	10	9.78	9.64
M8	1.25	22	28	41	8	7.78	7.64	14.38	14.2	5.3	5.45	5.15	5.54	5.06	13	12.73	12.57
M10	1.5	26	32	45	10	9.78	9.64	17.77	17.59	6.4	6.58	6.22	6.69	6.11	16	15.73	15.57
M12	1.75	30	36	49	12	11.73	11.57	20.03	19.85	7.5	7.68	7.32	7.79	7.21	18	17.73	17.57
(M14)	2	34	40	53	14	13.73	13.57	23.36	22.78	8.8	8.98	8.62	9.09	8.51	21	20.67	20.16
M16	2	38	44	57	16	15.73	15.57	26.75	26.17	10	10.18	9.82	10.29	9.71	24	23.67	23.16
(M18)	2.5	42	48	61	18	17.73	17.57	30.15	29.56	11.5	11.715	11.285	11.85	11.15	27	26.67	26.16
M20	2.5	46	52	65	20	19.67	19.48	33.53	32.95	12.5	12.715	12.285	12.85	12.15	30	29.67	29.16
(M22)	2.5	50	56	69	22	21.67	21.48	37.72	37.29	14	14.215	13.785	14.35	13.65	34	33.38	33
M24	3	54	60	73	24	23.67	23.48	39.98	45.2	15	15.215	14.785	15.35	14.65	36	35.38	35
(M27)	3	60	66	79	27	-	26.48	-	50.85	17	-	-	17.35	16.65	41	-	40
M30	3.5	66	72	85	30	-	29.48	-	55.37	18.7	-	-	19.12	18.28	46	-	45
(M33)	3.5	-	78	91	33	-	32.38	-	60.79	21	-	-	21.42	20.58	50	-	49
M36	4	-	84	97	36	-	35.38	-	66.44	22.5	-	-	22.92	22.08	55	-	53.8
(M39)	4	-	90	103	39	-	38.38	-	71.3	25	-	-	25.42	24.58	60	-	58.8
M42	4.5	-	96	109	42	-	41.38	-	76.95	26	-	-	26.42	25.58	65	-	63.1
(M45)	4.5	-	102	115	45	-	44.38	-	82.6	28	-	-	28.42	27.58	70	-	68.1
M48	5	-	108	121	48	-	47.38	-	88.25	30	-	-	30.42	29.58	75	-	73.1
(M52)	5	-	116	129	52	-	51.26	-	93.56	33	-	-	33.5	32.5	80	-	78.1
M56	5.5	-	-	137	56	-	55.26	-	99.21	35	-	-	35.5	34.5	85	-	82.8
(M60)	5.5	-	-	145	60	-	59.26	-	104.86	38	-	-	38.5	37.5	90	-	87.8
M64	6	-	-	153	64	-	63.26	-	-	40	-	-	40.5	39.5	95	-	92.8

# ISO 4017-2011 HEXAGON HEAD SCREWS(FULL THREAD)

Hot Dip Galvanized /Zinc plated & Black (Grade 4.8/8.8/10.9)



Material Standard: ISO 898-1  
 Specification : ISO 4017  
 Hot Dip Galvanized: ISO 1461-2009/ISO 10684  
 Zinc Plated: ISO 4042  
 Black plated : ISO 11048-1999

Unit: mm

Nominal size and thread diameter d	p	e		nomal	k				k <sub>1</sub>		nomal	s	
		grade A	grade B		grade A		B级		A级	B级		A级	B级
		min	min		max	min	max	min	min	min		min	
M6	1	11.05	10.89	4	4.15	3.85	4.24	3.76	2.7	2.63	10	9.78	9.64
M8	1.25	14.38	14.2	5.3	5.45	5.15	5.54	5.06	3.61	3.54	13	12.73	12.57
M10	1.5	17.77	17.59	6.4	6.58	6.22	6.69	6.11	4.35	4.28	16	15.73	15.57
M12	1.75	20.03	19.85	7.5	7.68	7.32	7.79	7.21	5.12	5.05	18	20.67	17.57
(M14)	2	23.36	22.78	8.8	8.98	8.62	9.09	8.51	6.03	5.96	21	23.67	20.16
M16	2	26.75	26.17	10	10.18	9.82	10.29	9.71	6.87	6.8	24	26.67	23.16
(M18)	2.5	30.14	29.56	11.5	11.715	11.285	11.85	11.15	7.9	7.81	27	29.67	26.16
M20	2.5	35.53	32.95	12.5	12.715	12.285	12.85	12.15	8.6	8.51	30	33.38	29.16
(M22)	2.5	37.72	37.29	14	14.245	13.785	14.35	13.65	9.65	9.56	34	35.38	33
M24	3	39.98	39.55	15	15.215	14.785	15.35	14.65	10.35	10.26	36	-	35
(M27)	3	-	45.2	17	-	-	17.35	16.65	-	11.66	41	-	40
M30	3.5	-	50.85	18.7	-	-	19.12	18.28	-	12.8	46	-	45
(M33)	3.5	-	55.37	21	-	-	21.42	20.58	-	14.41	50	-	49
M36	4	-	60.79	22.5	-	-	22.92	22.08	-	15.46	55	-	53.8
(M39)	4	-	66.44	25	-	-	25.42	24.58	-	17.21	60	-	58.8
M42	4.5	-	71.3	26	-	-	26.42	25.58	-	17.91	65	-	63.1
(M45)	4.5	-	76.95	28	-	-	28.42	27.58	-	19.31	70	-	68.1
M48	5	-	82.6	30	-	-	30.42	29.58	-	20.71	75	-	73.1
(M52)	5	-	88.25	33	-	-	33.5	32.5	-	22.75	80	-	78.1
M56	5.5	-	93.56	35	-	-	35.5	34.5	-	24.15	85	-	82.8
(M60)	5.5	-	99.21	38	-	-	38.5	37.5	-	26.25	90	-	87.8
M64	6	-	104.86	40	-	-	40.5	39.5	-	27.65	95	-	92.8

# ISO 4032-2012 HEXAGON NUTS

Hot Dip Galvanized /Zinc plated & Black (Grade 4.8/8.8/10.9)

Hot dip galvanized / zinc plated & black (Grade 4.8/8.8/10.9)

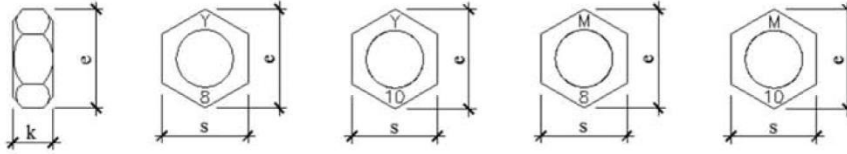

Material Standard: ISO 898-2  
 Specification : ISO 4032  
 Hot Dip Galvanized: ISO 1461-2009/ISO 10684  
 Zinc Plated: ISO 4042  
 Black plated : ISO 11048-1999

Unit: mm

Nominal size and thread diameter d	p	e	k		s	
	pitch of thread	min	max	min	max	min
M5	0.8	8.79	4.7	4.4	8	7.78
M6	1	11.05	5.2	4.9	10	9.78
M8	1.25	14.38	6.8	6.44	13	12.73
M10	1.5	17.77	8.4	8.04	16	15.73
M12	1.75	20.03	10.8	10.37	18	17.73
(M14)	2	23.36	12.8	12.1	21	20.67
M16	2	26.75	14.8	14.1	24	23.67
(M18)	2.5	29.56	15.8	15.1	27	26.16
M20	2.5	32.95	18	16.9	30	29.16
(M22)	2.5	37.29	19.4	18.1	34	33
M24	3	39.5	21.5	20.2	36	35
(M27)	3	45.2	23.8	22.5	41	40
M30	3.5	50.85	25.6	24.3	46	45
(M33)	3.5	55.37	28.7	27.4	50	49
M36	4	60.79	31	29.4	55	53.8
(M39)	4	66.44	33.4	31.8	60	58.8
M42	4.5	71.3	34	32.4	65	63.1
(M45)	4.5	76.95	36	34.4	70	68.1
M48	5	82.6	38	36.4	75	73.1
(M52)	5	88.25	42	40.4	80	78.1
M56	5.5	93.56	45	43.4	85	82.8
(M60)	5.5	99.21	48	46.4	90	87.8
M64	6	104.86	51	49.1	95	92.8



**ISO 7089**
**FLAT WASHER**

Hot Dip Galvanized /Zinc plated &amp; Black

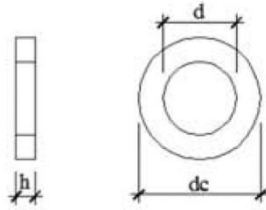

Material Standard: ISO 887  
 Specification : ISO 4032  
 Hot Dip Galvanized: ISO 1461-2009/ISO 10684  
 Zinc Plated: ISO 4042  
 Black plated : ISO 11048-1999

Unit: mm

Nominal size and thread diameter d	d		k		s		
	min	max	max	min	normal	max	min
φ5	5.3	8.79	10	9.64	1	1.1	0.9
φ6	6.4	11.05	12	11.57	1.6	1.8	1.4
φ8	8.4	14.38	16	15.57	1.6	1.8	1.4
10	10.5	17.77	20	19.48	2	2.2	1.8
φ12	13	20.03	24	23.48	2.5	2.7	2.3
(φ14)	15	23.36	28	27.48	2.5	2.7	2.3
φ16	17	26.75	30	29.48	3	3.3	2.7
(φ18)	19	29.56	34	33.38	3	3.3	2.7
φ20	21	32.95	37	36.38	3	3.3	2.7
(φ22)	23	37.29	39	38.37	3	3.3	2.7
φ24	25	39.5	44	43.38	4	4.3	3.7
(φ27)	28	45.2	50	49.38	4	4.3	3.7
φ30	31	50.85	56	55.26	4	4.3	3.7
(φ33)	34	55.37	60	58.8	5	5.6	4.4
φ36	37	60.79	66	64.8	5	5.6	4.4
(φ39)	42	66.44	72	70.8	6	6.6	5.4
φ42	45	71.3	78	76.8	8	9	7
(φ45)	48	76.95	85	83.6	8	9	7
φ48	52	82.6	92	90.6	8	9	7
(φ52)	56	88.25	98	96.6	8	9	7
φ56	62	93.56	105	103.6	10	11	9
(φ60)	66	99.21	110	108.6	10	11	9
φ64	70	104.86	115	113.6	10	11	9

Hot Dip Galvanized and Black (Grade 8.8/10.9)

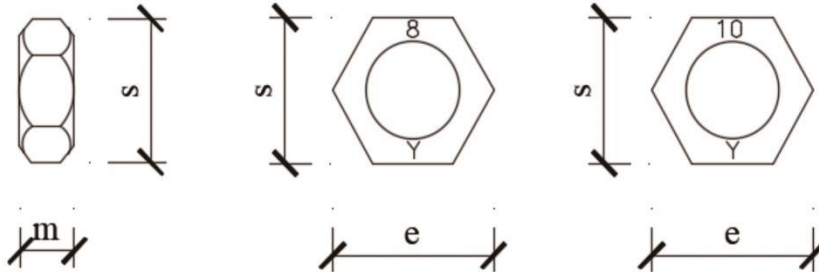

Material Standard: ISO 898-2009/AS/NZS 4291.1  
 Specification : AS 1252  
 Hot Dip Galvanized: ISO 1461-2009, AS/NZS 1214  
 Zinc Plated: ISO 11048-1999/GB T15519-2002

Unit: mm

nominal size and thread diameter	width across flats		width across corners		thickness	
	s		e		m	
size	max	min	max	min	max	min
M16	27.00	26.16	31.20	29.56	17.10	16.40
M20	34.00	33.00	39.26	37.29	20.70	19.40
(M22)	36.00	35.00	41.60	39.55	23.60	22.30
M24	41.00	40.00	47.30	45.20	24.20	22.90
(M27)	46.00	45.00	53.10	50.85	27.60	26.30
M30	50.00	49.00	57.70	55.37	30.70	29.10
M36	60.00	58.80	69.30	66.44	36.60	35.00

# AS/NZS 1252 STEEL FLAT WASHERS FOR HIGH-STRENGTH STRUCTURAL WASHER

Hot Dip Galvanized and Black (Grade 8.8/10.9)

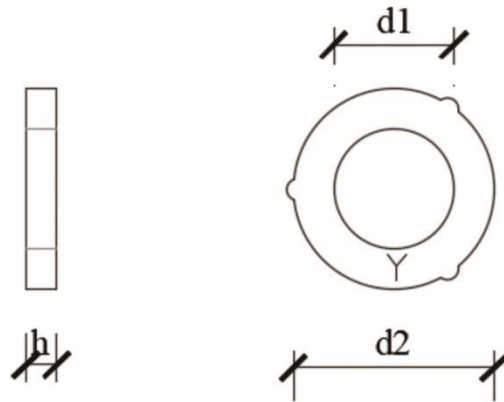

Material Standard: ISO 898-2009/AS/NZS 4291.1  
 Specification : AS 1252  
 Hot Dip Galvanized: ISO 1461-2009, AS/NZS 1214  
 Zinc Plated: ISO 11048-1999/GB T15519-2002

Unit: mm

nominal size and thread diameter	width across flats		width across corners		thickness	
	d1		d2		h	
size	min	max	min	max	min	max
M14	18.00	18.43	32.40	34.00	3.10	4.60
M16	22.00	22.52	40.40	42.00	3.10	4.60
M20	24.00	24.52	42.40	44.00	3.40	4.60
M24	26.00	26.52	48.40	50.00	3.40	4.60
M27	30.00	30.52	54.10	56.00	3.40	4.60
M30	33.00	33.62	58.10	60.00	3.40	4.60
M36	39.00	39.62	70.10	72.00	3.40	4.60

# HIGH STRENGTH THREADED BAR SYSTEM

**Surface:** Hot dipped galvanized available;  
Epoxy coated available;  
Anti-rust processing available

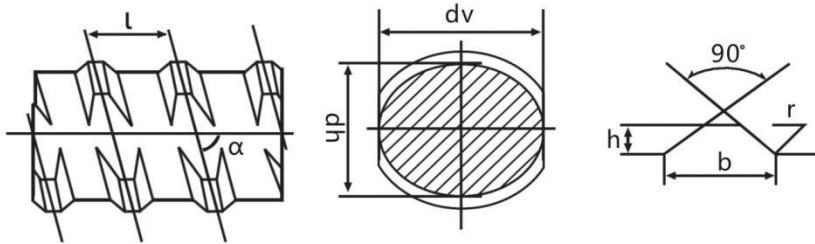

Diameter /mm	dh/mm		dv/mm		h/mm		b/mm		l/mm		r/mm	α
	Size	Tolerance	Size	Tolerance	Size	Tolerance	Size	Tolerance	Size	Tolerance		
15	14.7	±0.2	14.7	±0.5	1.0	±0.2	4.2	±0.3	10.0	±0.2	0.5	78.5°
20	20.0	±0.4	20.0	+0.4-0.8	1.3	±0.3	4.8	±0.5	10.0		1.2	80.5°
25	25.0		25.0	+0.4-0.8	1.6		6.0		1.5		81°	
32	32.0	±0.5	32.0	+0.5-1.2	2.0	±0.4	7.0		16.0	2.0	81.5°	
36	36.0		36.0		2.2	±0.4	8.0		18.0	2.5	81.5°	
40	40.0		40.0		2.5	±0.5	8.0		20.0	±0.3	2.5	81.5°
50	50.0		50.0		3.0	-0.5	9.0	24.0	2.5	81.5°		
63.5	63.5		63.5		3.0	±0.6	12.0	22.0	±0.4	2.5	84°	



# MECHANICAL PROPERTIES OF HIGH STRENGTH THREADED BAR

Mechanical Properties														
Diameter /mm	Cross-sectional area/mm <sup>2</sup>	Weight (kg/m)	PSB830				PSB930				PSB1080			
			Min Yield Stress/Load		Min Ultimate Stress/Load		Min Yield Stress/Load		Min Ultimate Stress/Load		Min Yield Stress/Load		Min Ultimate Stress/Load	
			Mpa	KN	Mpa	KN	Mpa	KN	Mpa	KN	Mpa	KN	Mpa	KN
15	177	1.4	830	147	1030	182	930	165	1080	191	1080	191	1230	218
20	314	2.47	830	261	1030	323	930	292	1080	339	1080	339	1230	386
25	491	4.1	830	408	1030	506	930	457	1080	530	1080	530	1230	604
32	804	6.65	830	667	1030	828	930	748	1080	868	1080	868	1230	989
36	1018	8.41	830	845	1030	1049	930	947	1080	1099	1080	1099	1230	1252
40	1257	10.34	830	1043	1030	1295	930	1169	1080	1358	1080	1358	1230	1546
50	1963	16.28	830	1627	1030	2022	930	1826	1080	2120	1080	2120	1230	2414
Elongation at fracture A/%			≥7				≥7				≥6			
Total Elongation at max force Agt/%							≥3.5							
Relaxation at 1000h							≤4							
Modulus of elasticity/Mpa							2×10							

# HIGH STRENGTH THREADED BAR AND ACCESSORY

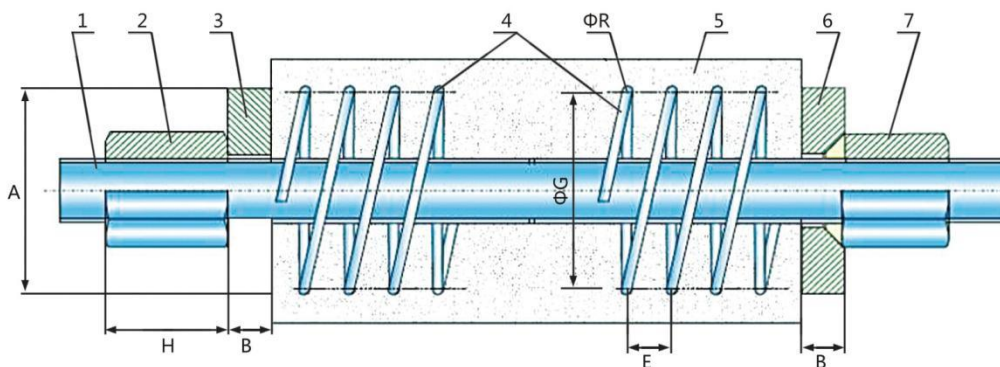

**1 Full Thread Bar**  
精轧螺纹钢

**2 Flat Hex Nut**  
平螺母

**3 Flat Plate**  
平垫板

**4 Spiral Rod**  
螺旋筋

**5 Concrete**  
混凝土

**6 Spherical Plate**  
锥垫板

**7 Spherical Hex Nut**  
锥螺母

# HIGH STRENGTH THREADED BAR SYSTEM

## Flat Hex Nuts & Spherical Hex Nut

Normally there are Full hex nut and spherical hex nut used in construction.

There is also lock nut, which is shorter and thinner than normal hex nut in the tensioning end.

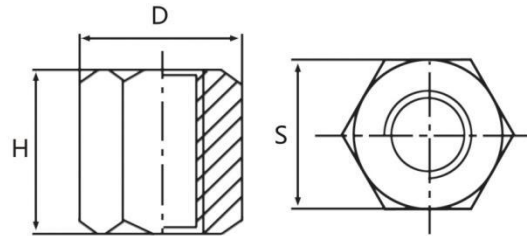

Material 45#, 40Cr

D mm	S mm	H mm	D mm	KG
15	30	50	34.5	0.22
15	30	100	34.5	0.45
20	32	45	37	0.17
25	50	60	55	0.70
32	65	72	75	1.40
36	65	80	75	1.45
40	70	100	81	2.12
50	80	110	92	3.1

## Domed Nut (Heavy Duty)

Sizes can be as customer's drawing.

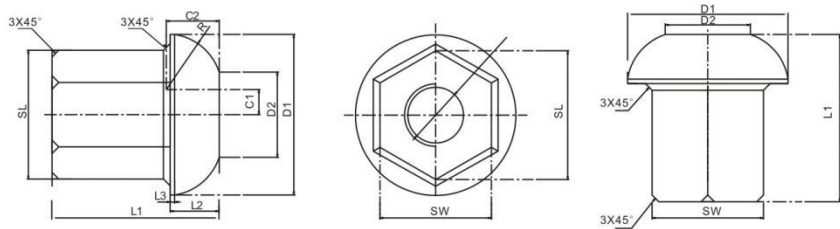

Material 45#, 40Cr

Dia.	Dimension					
	SW	SL	D1	D2	L1	L2
18	36	42	50	30	55	15
25	50	58	72	38	75	22
32	60	69	80	45	90	28
36	65	75	90	50	100	30
40	70	81	100	55	115	32
50	85	98	120	64	145	36

# HIGH STRENGTH THREADED BAR SYSTEM

## Coupler

Coupler is designed to connect the thread bar to increase the length where projects request.



Material 45#, 40Cr, 35CrMo, 42CrMo

D mm	D mm	L mm	KG
15	38	110	0.8
20	38	110	0.7
25	50	132	1.35
32	60	168	2.4
36	70	200	3.6
40	75	220	5.2
50	90	270	9.8

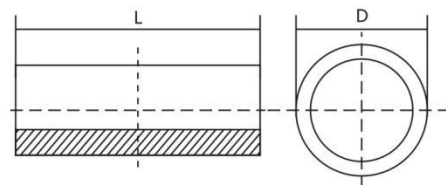

## Anchor Plate

Anchor plate works closely working with the Nuts. And there are different types like flat, domed, spherical plate ect.

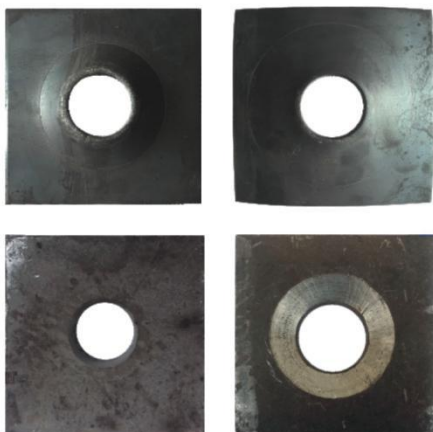

Material 235B, Q345B

D mm	a mm	h mm	Material	KG
15	100	8	Q235	0.6
20	100	30	Q235	2.2
25	150	35	Q235	5.9
32	180	40	Q235	9.6
36	200	45	Q235	13.4
40	220	50	Q235	18.0
50	240	55	Q235	33.6

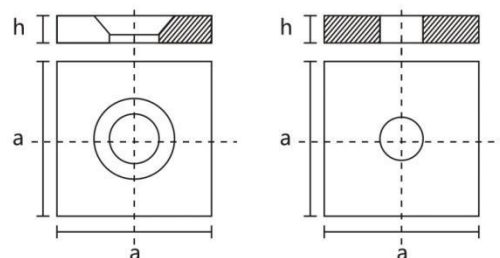

# HOT ROLLED FORMWORK TIE ROD 15/17MM

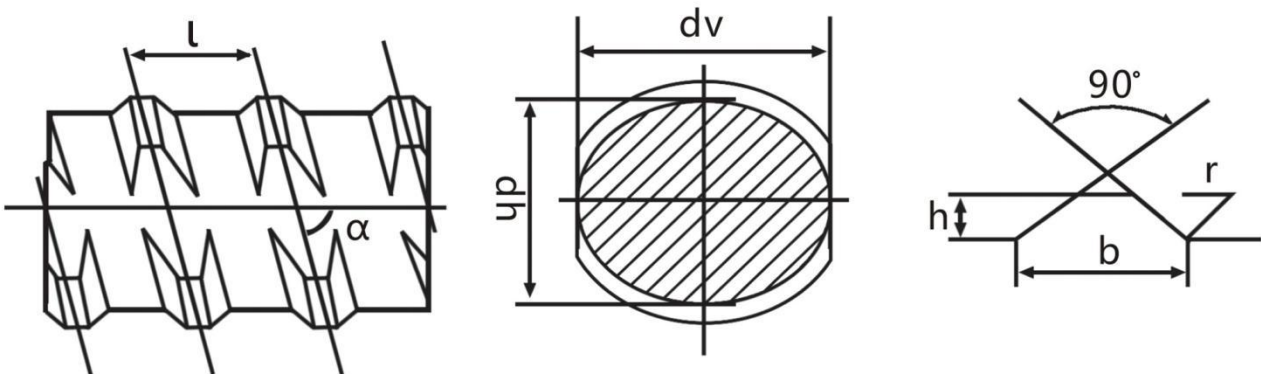

Dia	dh/mm	dv/mm	h/mm	b/mm	l/mm	r	a
15	14.70 ±0.2	14.40 ±0.5	1.00 ±0.2	4.20 ±0.3	10.00 ±0.2	0.5	78.5°

<b>Yield/Tensile</b>	830/1030 Mpa
<b>YieldTensile</b>	147/182 KN
<b>Elongation</b>	7%
<b>Weight</b>	1.4 KG/M

## Application

- Tie Rod
- Formwork
- Scaffolding
- Hook Anchor



## FORMWORK ACCESSORY

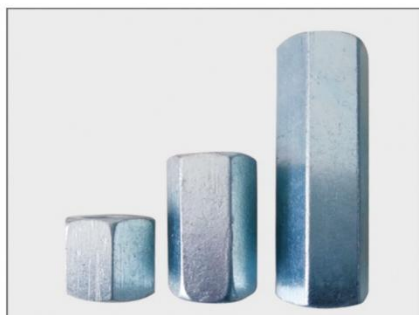

**Hex Nut**



**Wing Nut**



**Wing Nut**



**Wing Nut**



**Wing Nut**



**Water Stopper**



**Combine Nut Plate**



**Steel Cone**

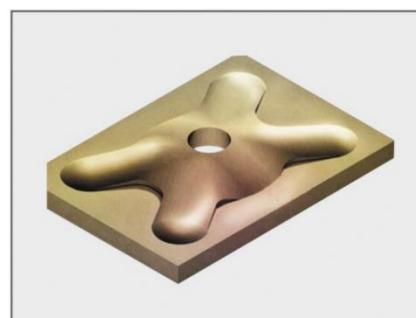

**Steel Plate**

We can also produce as your drawing.

## THREADED BARS/HIGH STRENGTH THREADED ROD

**Diameter:** M20-100

**Grade:** 8.8,10.9

**Material:** 40CR.35CrMoA, 42CrMoA, A193-B7

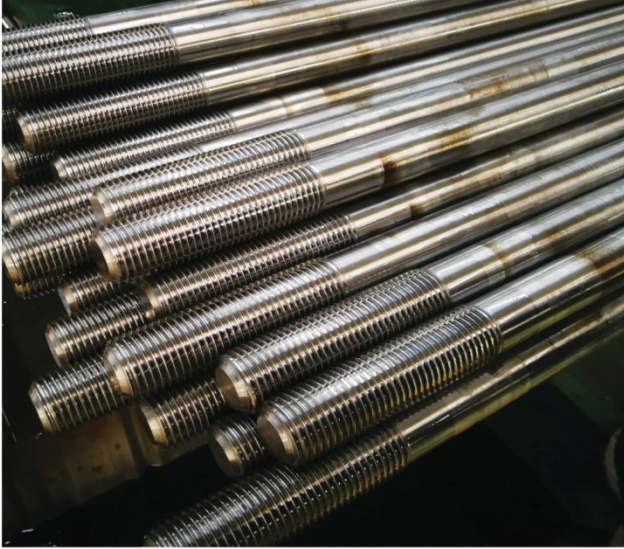

## SPACER / CENTRALIZER

**Diameter:** 25mm-50mm



## GROUTING SLEEVE

**Diameter:** 12mm-40mm



# REBAR SLEEVE

**Material:** HRB400

**Application:** Construction . Embedded . Fastening . Lifting

Rebar Diamter/mm	Rebar Sleeve Size/mm
22	14*80
22	14*100
25	16*80
25	16*100
28	18*150
32	20*(75-250)



# ANCHORAGE FOR HEADED BARS

## Advantage

- Saving & reducing steel
- Fast & Easy installation An ideal solution for designers, contractors, steel fabricators



Rebar Diamter /mm	Size/mm	Half Anchorage		Full Anchorage	
		D/mm	H/mm	D/mm	H/mm
16	M16.55×2.0	38	16	51	16
18	M18.60×2.5	43	18	58	18
20	M20.60×2.5	48	20	64	20
22	M22.60×2.5	52	22	70	22
25	M25.65×3.0	60	25	80	25
28	M28.65×3.0	66	28	89	28
32	M32.65×3.0	75	32	102	32
36	M36.65×3.0	85	36	115	36
40	M40.65×3.0	95	40	127	40
50	M50.65×3.0	118	50	159	50

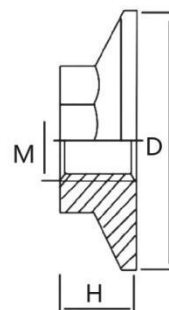

## THREADED BAR PRODUCTION



**Hot Rolling**



**Automatic processing line**

## ACCESSORY PRODUCTION



**Hot forging**

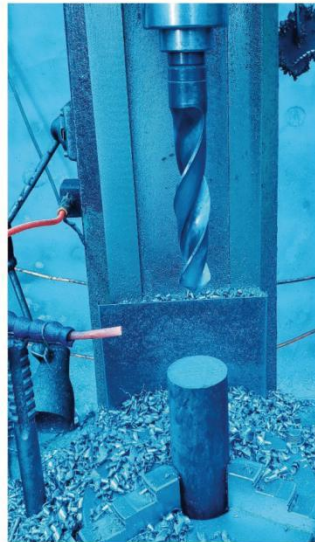

**Drilling**



**Sawing**



**Punching**

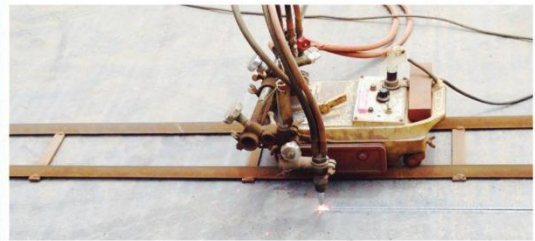

**Gas Cutting**

## QUENCHING & TEMPERING



## TENSILE TEST



















## PRODUCT LIST

Item	Classification	Description	Standard	Refer ence photo	Remark
1	Sturctural bolting	High-strength steel bolts assembly Steel grade:8.8/10.9	BS EN 14399-1 BS EN 14399-3		Hot dip galvanized ISO1461:2009/EN ISO 10684 Black ISO 11408:1999 Phosphorization
2	Sturctural bolting	Pre-Loading bolts assembly HRC Steel grade:10.9	BS EN 14399-10		Hot dip galvanized ISO1461:2009/EN ISO 10684 Black ISO 11408:1999 Phosphorization
3	Sturctural bolting	High-strength steel bolts assembly Steel grade:8.8/10.9	DIN 6914-1989 DIN 6915-1989		Hot dip galvanized ISO1461:2009 Black ISO 11408:1999 Phosphorization
4	Sturctural bolting	High-strength steel bolts assembly Steel grade:8.8/10.9	AS 1252-1996		Hot dip galvanized ISO1461:2009/AS 1214:1983 Black ISO 11408:1999 Phosphorization
5	Sturctural bolting	High-strength steel bolts assembly Steel grade:8.8	ASTM A325M		Hot dip galvanized ASTM A153C/ISO 1461:2009 Black ISO 11408:1999
6	Sturctural bolting	High-strength steel bolts assembly Steel grade:8.8/10.9	GB 1228-2006 GB 1229-2006		Hot dip galvanized ISO1461:2009 Black ISO 11408:1999 Phosphorization
7	General bolting	High-strength (fully threaded) Steel grade:4.8/8.8	DIN 933 BS 4190 BS 3692 ISO 4017 GB 5783		Hot dip galvanized ISO1461:2009 Black ISO 11408:1999 Phosphorization
8	General bolting	Hexagon bolt(fully threaded) Stainless Steel:A2/A4	DIN 933		Stainless Steel ISO 3506-1:2009
9	General bolting	Hexagon bolt(partial threaded) Steel grade:4.8/8.8	DIN 931 BS 4190 BS 3692 EN ISO 4017 GB 5782		Zinc ISO 4042:2001 Hot dip galvanized ISO 1461:2009 Black ISO 11408:1999 Stainless Steel ISO 3506-1:2009
10	General bolting	Hexagon bolt(partial threaded) Stainless Steel:A2/A4	DIN 931		Stainless Steel ISO 3506-1:2009
11	General bolting	Cup SQ Bolts(Coach bolts) Steel grade:4.6/8.8	DIN 603		Zinc ISO 4042:2001 Hot dip galvanized ISO 1461:2009 Black ISO 11408:1999 Stainless Steel ISO 3506-1:2009
12	General bolting	Cup SQ Bolts(Coach bolts) Steel Steel:A2/A4	DIN 603		Stainless Steel ISO 3506-1:2009
13	General bolting	Lifting bolt	DIN 580		Zinc ISO 4042:2001 Stainless Steel ISO 1461:2009
14	General bolting	Mushroom bolt Steel grade:8.8	DIN 898		Stainless Steel ISO 3506-1:2009
15	General bolting	Eye bolt	GB/T798-1988		Zinc ISO 4042:2001 Stainless Steel ISO 3506-1:2009

# PRODUCT LIST

Item	Classification	Description	Standard	Refer ence photo	Remark
16	Sockets	Cap Screw Socket Steel grade 4.8/8.8	DIN 912 GB/T70.1		Hot dip galvanized ISO 1461:2009
17	Sockets	Cap Screw Socket Stainless Steel A2/A4	DIN 912 GB/T70.1		Black ISO 11408:1999
18	Sockets	Cap Screw Socket Steel grade 4.8/8.8	DIN 7991 GB/T70.3		Zinc ISO 4042:2001 Black ISO 11408:1999
19	Sockets	Countersunk Socket Stainless Steel A2/A4	DIN 7991 GB/T70.3		Stainless Steel ISO 3506-1:2009
20	Sockets	Hexaogn socket button head screws Stainless Steel A2/A4	ISO7380		Stainless Steel ISO 3506-1:2009
21	PTFE bolting	PEFE Heavy double head stud Steel grade B7	ASME B 18.2.2		PTFE Black ISO 11408:1999
22	Stud rod	Threaded rod Stainless steel:A2/A4	DIN 975 ISO 898-1:2009		Stainless Steel ISO 3506-1:2009
23	Stud rod	Threaded rod Steel grade:8.8	DIN 975 ISO 898-1:2009		Hot dip galvanized ISO1461:2009
24	Stud rod	Double-end stud and flange bolting stud Steel grade8.8/10.9	ASTM B 18.1.2		Black ISO 11408:1999
25	Stud rod	“U”Double head stud Stainless steel:A4	DIN 975		Stainless Steel ISO 3506-1:2009
26	Nuts	Hex Nuts Steel grade 8/10 Stainless steel A2/A4	DIN 934 BS 4190 BS 3692 ISO 4032:2001 GB 6170		Zinc ISO 4042:2001 Hot dip galvanized ISO 1461:2009 Stainless Steel ISO 3506-2:2009
27	Nuts	Heavy Hex Nuts Steel grade 8/10	BS EN 14399 DIN 6915 AS1252 ASME B 18.2 GB 1229		Hot dip galvanized ISO 1461:2009 Black ISO 11408:1999 Phosphorization
28	Nuts	Nyloc Nuts Steel grade 8/10 Stainless steel A2/A4	DIN 985 GB/T6184		Zinc ISO 4042:2001 Stainless Steel ISO 3506-2:2009
29	Nuts	Flange Nuts Stainless stell A2/A4	DIN 6923 GB/T6177.1 GB/T6187.1		Stainless Steel ISO 3506-2:2009
30	Nuts	Welding Nuts Steel grade 4/8 Stainless stell A2/A4	DIN 929 GB/13681		Zinc ISO 4042:2001 Hot dip galvanized ISO 1461:2009 Black ISO 11408:1999 Stainless Steel ISO 3506-2:2009

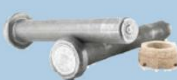
# PRODUCT LIST

Item	Classification	Description	Standard	Refer ence photo	Remark
31	Nuts	Dome Nuts Stainless stell A2/A4	DIN 1587 GB/T923		Stainless Steel ISO 3506-2:2009
32	Nuts	Wing Nuts Steel grade 4 Stainless stell A2/A4	DIN 315		Zinc ISO 4042:2001 Hot dip galvanized ISO 1461:1999 Stainless Steel ISO 3506-1:2009
33	Nuts	Square Nuts Steel grade 4 Stainless stell A2/A4	DIN 562		Zinc ISO 4042:2001461 : 2009 Stainless Steel
34	Washer	Flat washer Steel Stainless stell A2/A4	DIN 125 BS 4320 GB97.1		Zinc ISO 4042:2001 Hot dip galvanized ISO 1461:2009 Stainless Steel
35	Washer	Spring washer Steel Stainless stell A2/A4	DIN 127 GB T93		Zinc ISO 4042:2001 Hot dip galvanized ISO 1461:2009 Stainless Steel
36	Washer	Structural Steel Flat washer Steel	AS 1252		Hot dip galvanized ISO 1461:2009
37	Screws	Twinfat Wood Screw Steel grade A2/A4	DIN 571		Stainless Steel ISO 3506-1:2009
38	Screws	Countersunk hesd machine screw Stainless Steel A2/A4	DIN 965 GB/YB 819		Stainless Steel ISO 3506-1:2009
39	Screws	Pan head machine screws Stainless stell A2/A4	DIN 7985 GB/YB818		Stainless Steel ISO 3506-1:2009
40	Screws	Countersunk head self dirling screws Stainless stell A2/A4	ISO 15482		Stainless Steel ISO 3506-1:2009
41	Screws	Plan hesd self dirling screws Stainless stell A2/A4	GB 15856.1		Stainless Steel ISO 3506-1:2009
42	Screws	Hexagon self driling scerws Stainless stell A2/A4	GB/T 15856.4		Stainless Steel ISO 3506-1:2009
43	Screws	Countersunk head self tapping screws Stainless stell A2/A4	DIN 7982 GB/YB 846		Stainless Steel ISO 3506-1:2009
44	Screws	Plan hesd self tapping screws Stainless stell A2/A4	DIN 7981 GB/YB 845		Stainless Steel ISO 3506-1:2009
45	Connector	Shear Connector/Shear Stud Low Carbon Steel/ML15AL	ISO 13918 AWS D1.1 GB/T 10433 AS/NZS 1554		Phosphorization
	Accessories	Ceramic Ferrule	ISO 13918		Yello brown mixed color